

Uniting people with property... since 1986



15/1679 Remembrance Driveway Picton NSW

4 🏠 3 🚗 8 🚗

Land Size : 1.05 ha

View : <https://www.acreagesales.com.au/7943192>



Shane Brown
0246572166



Tanya Novek
0423426454

Tranquil Oasis: Conveniently Located Rural Bliss

Discover the charm of country living with modern convenience in this approx. 2.59-acre (approx. 1.05 ha) rural retreat, ideally located opposite Anthill golf course and nearby to Picton CBD, with a delightful brick residence and a fully self-contained studio retreat.

The home, a blend of elegance and comfort, features an open-plan kitchen with a gas cooktop, electric oven and dishwasher, seamlessly flowing into the living and dining areas. Sunlight streams through stunning French doors, leading to a backyard with a breathtaking rural vista.

The master suite offers a serene escape with an ensuite and walk-in robe. Two additional bedrooms and a study complete the main residence, alongside a delightful sun-room at the back which is a place to relax and truly appreciate your own tranquil oasis.

A separate one-bedroom granny flat with kitchenette, walk-in robe, spacious living area and private porch provides an ideal space for guests or extended family.

Outdoors, a large, 3-bay American barn-style shed provides ample storage and would be well-suited to tradies. The property's gently sloping land is very usable and adds to the country charm of this property.

This tranquil haven is not just a home, it's a lifestyle retreat. Inspect today.

Other highlight features:

- New, pure wool carpet
- Hybrid timber floors
- Double garage
- Approx. 110,000 L water tank
- Split-system air conditioning in home and studio
- Freshly painted in most areas
- NBN internet
- Approx. 2 km to Picton CBD with local eateries, supermarkets, medical facilities, hair dressers, etc.
- Located opposite Anthill Golf Course

* Please note that all webpage enquiries require a contact number AND an email address. Enquiries that do not have this information will not receive a response.

* Photo identification must be presented to the agent by all parties prior to inspections. All care has been taken in providing accurate information in this advertisement. However, prospective purchasers are to rely on their own enquiries.

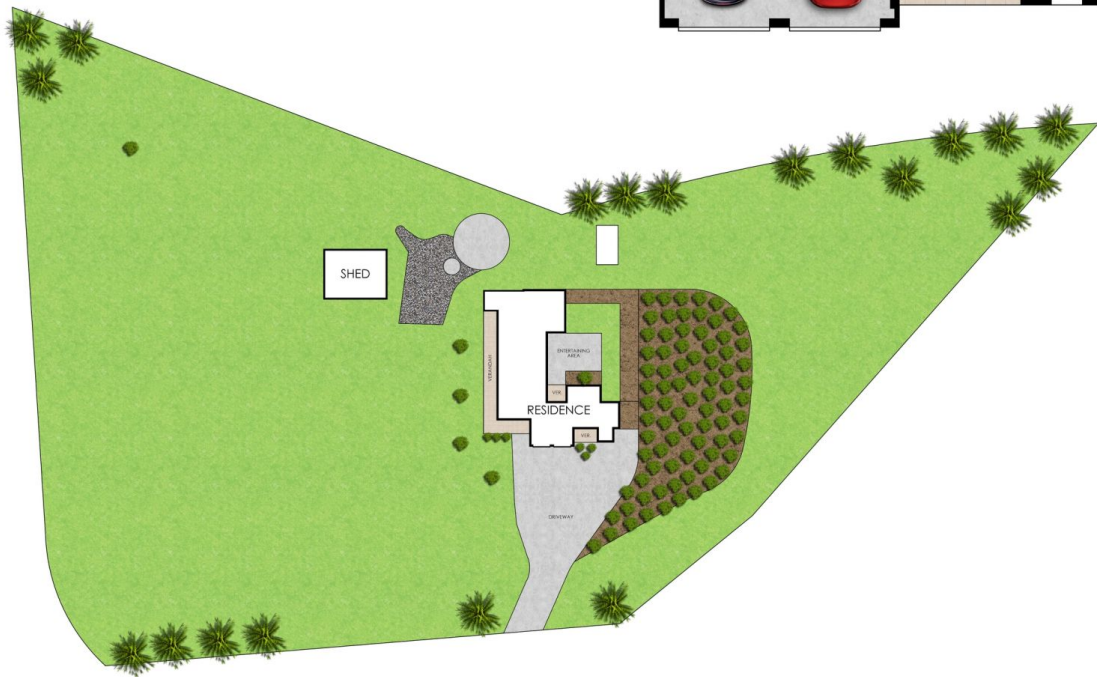
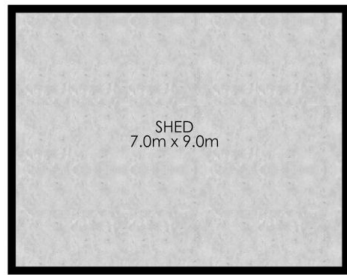

15/1679 Remembrance Driveway, Picton

Not to scale • All measurements are approximate • Drawn for marketing purposes only

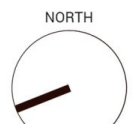

<https://www.acreagesales.com.au>
41 Wentworth Road, Bringelly NSW 2556

1/73 John Street, The Oaks NSW 2570
3/23-29 Argyle Street, Camden NSW 2570