



Uniting people with property... since 1986



1620 Greendale Road Wallacia NSW

3 3 3

Price : Price Guide \$2,000,000

Land Size : 5.02 Acres

View : <https://www.acreagesales.com.au/7930196>



**Wayne Grimson**  
0425340522



**Edwin Borg**  
0418236274

This private approx. 5.02 acre (approx. 2.03 ha) river fronted property boasts 3 bedrooms, 3 bathrooms, a spacious shed with attached studio/bedroom. The Nepean River forms part of the property's boundary and includes its very own jetty with vehicle and easy foot access.

This immaculately presented home has 2 bedrooms on the main level and a third bedroom with ensuite downstairs. The open plan design which incorporates the kitchen, living and dining spaces, features floor to ceiling windows that showcase the natural vistas. The space is warmed by an open fireplace or reverse cycle air-conditioning. It also incorporates a glass atrium bringing the outside in.

There are multiple alfresco areas in which to enjoy the diverse bird life or to socialise with friends and family. The paved BBQ area incorporates a fire pit and a sunken spa with views over the property's dam and river.

The approximately 10m x 7m shed includes a studio space + bathroom as well as air-conditioning and its own garden courtyard.

Other features:

- Electric entrance gates
- Gas cooktop
- Garden shed
- 2 x storage sheds
- Timber flooring throughout
- Main bathroom with claw foot bath
- Master bedroom with French doors to verandah
- Established gardens

\* Please note that all webpage enquiries require a contact number AND an email address. Enquiries that do not have this information will not receive a response.

\* Photo identification must be presented to the agent by all parties prior to inspections. All care has been taken in providing accurate information in this advertisement. However, prospective purchasers are to rely on their own enquiries.

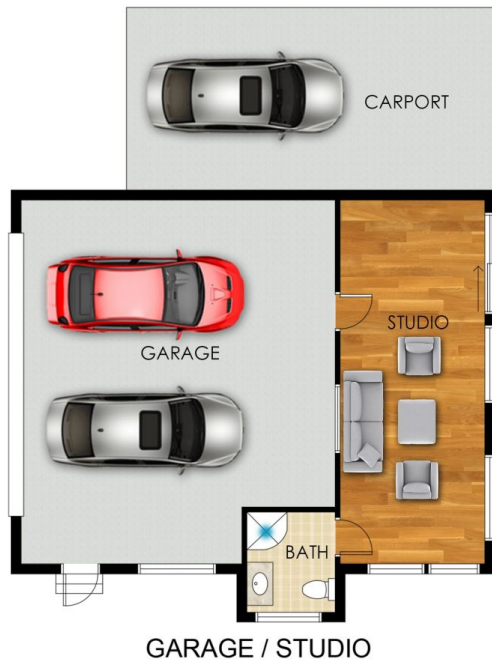

GARAGE / STUDIO

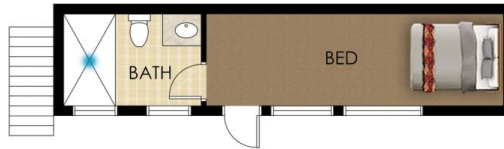

LOWER FLOOR



GROUND FLOOR



## 1620 Greendale Road, Wallacia

Floor plans and site plans are for illustrative purposes only. They are not part of any legal document or title and are subject to errors, omission, and inaccuracies. Whilst every attempt has been made to ensure the accuracy of this plan, measurements of doors, windows, rooms, cupboards etc are approximate only.