



Uniting people with property... since 1986



24 Milford Road Ellis Lane NSW

3 2 16

Price : \$ 1,300,000

Land Size : 4072 sqm

View : <https://www.acreagesales.com.au/7227747>



Tanya Novek
0423426454



Shane Brown
0246572166

Rural Retreat - Close to Camden

Located just minutes from beautiful Camden, sits this approx. 1 acre of beautiful land with a two-storey home and abundant shedding.

Tucked away in a quiet street in stunning Ellis Lane, this property boasts a double-storey, three-bedroom home with federation-style features. Greeting you with a gorgeous veranda out the front, perfect for sitting and enjoying the fresh air and rural vistas, and inside the home it is light-filled and spacious, with high ceilings and classic, exposed brick throughout.

All three bedrooms have built-in wardrobes, with one bedroom having direct access to the beautiful veranda. Upstairs sits the kitchen and dining room with access to the back veranda, while the lounge room allows access to the front veranda; allowing the perfect use of the indoors and outdoors. Downstairs features a formal living room/games room with a wet-bar and direct access to the garage.

If you're looking for shedding or space to store cars, boats, caravans and the like, then you'll love the double garage and attached 3-car carport off the house, plus massive 5-car carport, plus shed with enough room for 3-cars. There is also 3-phase power to the house and sheds.

Inspect today and start your dream acreage lifestyle so close to town.

Other features:

- Approx. 4,072 sq. m
- Split-system air conditioning
- Additional toilet inside laundry
- Beautiful, established gardens
- Red-robin hedging at the front, providing great privacy
- Drive-through/side access
- Town water
- Council: Camden

* Please note that all webpage enquiries require a contact number AND an email address. Enquiries that do not have this information will not receive a response.

* Photo identification must be presented to the agent by all parties prior to inspections. All care has been taken in providing accurate information in this advertisement. However, prospective purchasers are to rely on their own enquiries.

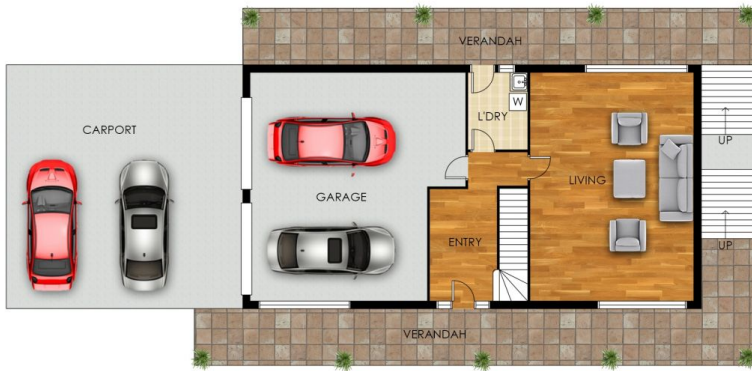

GROUND FLOOR



FIRST FLOOR

24 Milford Road, Ellis Lane



Floor plans and site plans are for illustrative purposes only. They are not part of any legal document or title and are subject to errors, omission, and inaccuracies. Whilst every attempt has been made to ensure the accuracy of this plan, measurements of doors, windows, rooms, cupboards etc are approximate only.