



Uniting people with property... since 1986



46 Steveys Forest Road Oakdale NSW

3 **1** **1**

Price : \$ 550,000

Land Size : 815 sqm

View : <https://www.acreagesales.com.au/3649215>



Edwin Borg
0418236274

Investment or First Starter

Be quick, this well-presented property set on a sizeable approx. 815 sq.m block is sure to appeal to both investors and first home owners alike.

Featuring a light-filled combined living/ dining space overlooking the lovely forested area at the rear, this home enjoys three good sized bedrooms plus a separate lounge for family entertaining.

The kitchen, which has a breakfast bar and tiled splash back, is in the heart of the home but it's outdoors where new owners could transform the current blank canvas from a home into a haven!

With the excellent side access, there's opportunity to extend the current house or add a shed (subject to council approval) then landscape till your heart's content, or simply move in and enjoy being a part of this popular family-friendly community of Oakdale.

Other features include:

- Approx. 815 sq.m
- Rates approx. \$295 Per Quarter
- Laundry with external access
- Single lock-up garage with external access
- Main bathroom with separate toilet
- Close to bus stop
- Close to Oakdale Public School

Photo identification must be presented to the agent by all parties prior to inspections. All care has been taken in providing accurate information in this advertisement. However, prospective purchasers are to rely on their own enquiries.

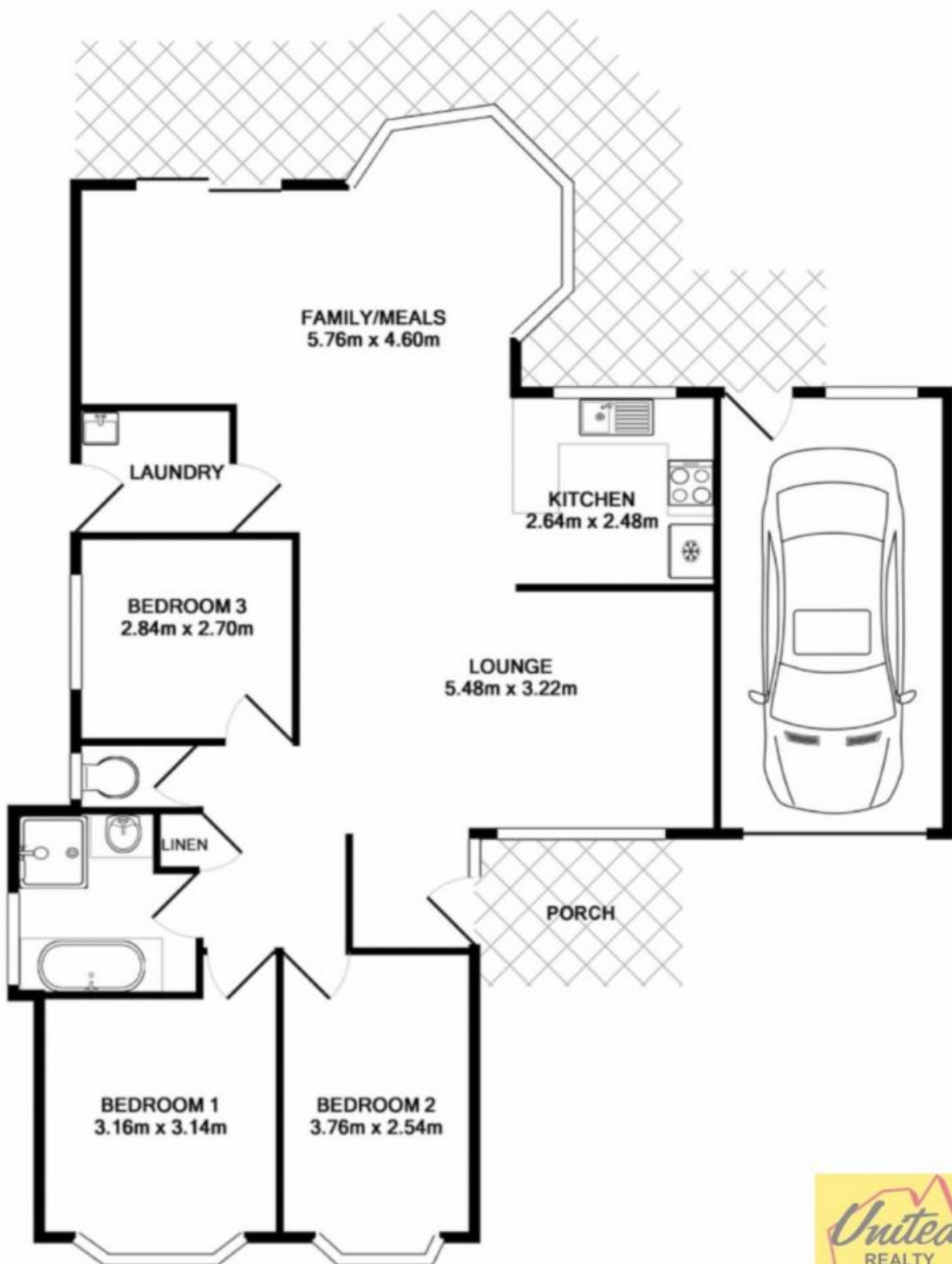

Measurements are approximate. Not to scale. Illustrative purposes only